

ADJUST-A-VIEW® QUARTER CIRCLE INSTALLATION INSTRUCTIONS

Moveable Arches by Omega



Omega Mfg. Corporation
Two Rivers, WI
(800) 874-9594
www.adjustaview.com
Proudly Serving Customers Since 1976

ADJUST-A-VIEW® QUARTER CIRCLE INSTALLATION INSTRUCTIONS

Moveable Arches by Omega

MATERIAL LIST

- ADJUST-A-VIEW® User Instructions
- ADJUST-A-VIEW® Installation Instructions
- Track Assembly
- Hand Shade
- Corner Hub Assembly
- Hardware Bag
 - Corner Hub Keeper Plate
 - Track Mounting Screws (1 ½" wood screws)
 - Corner Hub Mounting Screws (1" wood screw)
 - Track touchup paint

TOOLS REQUIRED

- Tape Measure
- Pencil
- #2 Phillips Screw Driver
- Electric Drill
- 3/32" Drill Bit

ADJUST-A-VIEW® QUARTER CIRCLE INSTALLATION INSTRUCTIONS

Moveable Arches by Omega

STEP 1. Unpack the carton.

- Carefully unpack the track assembly, shade, corner hub, and hardware bag and remove all packaging material. **NOTE: Remove “shipping” nuts and bolts from track and dispose.**

STEP 2. Install track assembly.

- Position track assembly in window frame. **Track must touch the vertical part of the window frame.** Cord loop will be located towards the room interior.
- Position track assembly in the window frame to a location where the track is approximately ¼” inside the window frame (units with motorization may need to mount flush). The arm where the cord comes out should be close to, but not touching the sill or trim mouldings.
- With your pencil, carefully mark the exact center of the mounting holes.
- Remove track assembly.
- Using the 3/32” drill bit, drill pilot holes for all mounting screws.
- Reposition track assembly and screw into position using mounting screws provided in hardware bag. Start at the top of the arch and work down, securing each screw tight as you go.



Mark hole centers.



Drill pilot holes.



Screw track to frame.

STEP 3. Mount corner hub.

- From the vertical frame measure 3/4” and scribe a line.
- Measure from the edge to the track. Add 1 ¼” to this dimension to get to the **final depth.**
- Center the corner hub keeper plate exactly over the scribed lines. With your pencil, carefully mark the exact center of the mounting holes.
- Using the 3/32” drill bit, drill pilot holes for mounting screws.
- Reposition corner hub keeper plate and screw into position using mounting screws provided in hardware bag.
- Position the corner hub on the corner hub keeper plate.

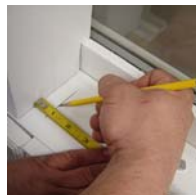

Measure 3/4 “ and scribe line.



Measure edge to track.



Add 1 1/4” and scribe line.

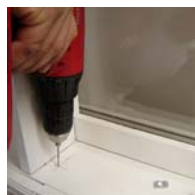

Drill pilot hole.



Screw keeper plate to sill.

ADJUST-A-VIEW® QUARTER CIRCLE INSTALLATION INSTRUCTIONS

Moveable Arches by Omega

STEP 4. **Mount cellular shade (for fabric shades go to STEP 5).**

- Position shade on sill. The colored fabric should be facing toward the room and the neutral fabric facing outside. The attachment spring, protruding from upper shade rail, will be positioned on the left side of the shade towards the window.
- Squeeze the spring to retract the “finger”, located near the window, into the shade rail. Carefully position the shade so the “finger” nearest you is lined up with the mounting hole found in the shade carrier. Rotate the shade rail slightly until the “finger” towards the window is lined up. Release the spring clip allowing the “finger” to engage the shade carrier. Check to insure both “fingers” are fully engaged in the shade carrier.
- Recheck the position of the shade in the hub. The shade should be located inside the hub “spring pin”.
- Carefully pull the cord. The shade should freely rise.
- Fully open and close the shade to insure proper operation.



Locate left hand shade.



Shade carrier.



Position shade on sill.



Squeeze spring.



Engage fingers in shade carrier.



Try shade to insure fingers are properly engaged in shade carrier.

STEP 5. **Mount cellular shade (for fabric shades go to STEP 5).** **Right hand arch installation**

- Position the right side “car” to the top of the arch by pulling the beaded cord loop.
- Locate “right side” shade.
- To help “control” the shade, leave the bands in place.
- Position the shade so that the plastic connectors are pointed upward and the “show side” fabric is facing toward you.
- Locate the insertion point at the end of the center track groove near the top of the right hand arch.
- Locate the connector furthest to the right. This will be the first connector inserted into the track.
- Insert the connector into the track and push it in the track to the right a few inches.
- Insert all but the last connector into the track.
- Insert the last connector (furthest to the left) into the plastic receiver mounted on the car.
- Using the pull cord, slowly lower the shade, center band still in place, until it rests on the sill. Take care to guide the shade into the hub and direct it until it is fully down resting on the sill.
- Remove the band and straighten any pleats that may be out of place.

ADJUST-A-VIEW® QUARTER CIRCLE INSTALLATION INSTRUCTIONS

Moveable Arches by Omega

- Slowly run the shade up to the closed position and return it to the opened position. The pleats should stack nicely.
- Repeat the procedure for the left hand arch.
- Fully open and close both shades. Magnets in the bottom of the shades will cause them to “snap” together.



Bring car to top of arch.



Identify right side shade.
Leave bands on.



Locate insertion point.



Insert connectors into track.



Insert last connector into plastic receiver.



After carefully lowering shade and straightening pleats, raise and lower shade.

STEP 6. Mount cord loop tension brackets.

- Locate a suitable location to attach the cord loop tension bracket.
- Insure cords are not twisted.
- Attach cord loop tension bracket with screws provided in hardware bag.
- **NOTE: Failure to install cord loop tension bracket on the cord loop could result in a potentially unsafe condition and cause personal injury.**



Locate tension bracket.



Mark hole centers.



Drill pilot holes.



Screw in place.

STEP 7. Demonstrate operation to customer.

- Demonstrate proper operation of the window treatment to the customer, including removal of shade for window washing, etc. Present User Manual to the customer and discuss its use. Also, discuss what to do if the cord is stuck. Stress to the customer that one should NEVER yank the cord.



Demonstrate proper operation to customer